

30th & Mitthoeffer

10040-10110 E. 30th St.
Indianapolis, IN 46219
Marion County



key features

- 3.25-acre parcel available
- zoned C3
- almost 5,000 households within one mile
- daily traffic counts: 16,880 on 30th Street and 15,134 on Mitthoeffer Road

demographics

| | 1 mile | 3 miles | 5 miles |
|-----------------------|----------|----------|----------|
| population | 11,759 | 87,498 | 162,611 |
| households | 4,817 | 33,313 | 63,919 |
| avg. household income | \$67,810 | \$73,838 | \$82,486 |
| daytime population | 6,883 | 52,719 | 109,800 |

2024 Estimates. Source: Applied Geographic Solutions 5/2024, TIGER Geography

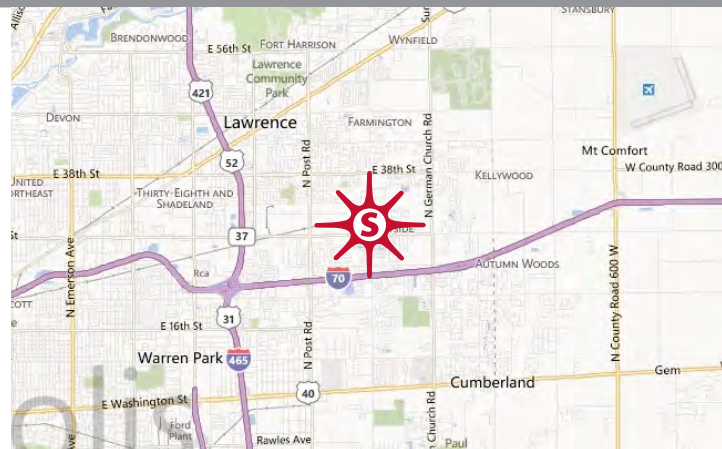

land for sale/lease/build-to-suit 3.25 acres

Thomas Siffermann 317.524.7819 tsiffermann@sandordev.com

10689 N. Pennsylvania St., Suite 100, Indianapolis, IN 46280

www.sandordev.com
sandor