

Scottsdale Place

5705 & 5725 N. Scottsdale Rd.
Scottsdale, AZ 85250
Maricopa County

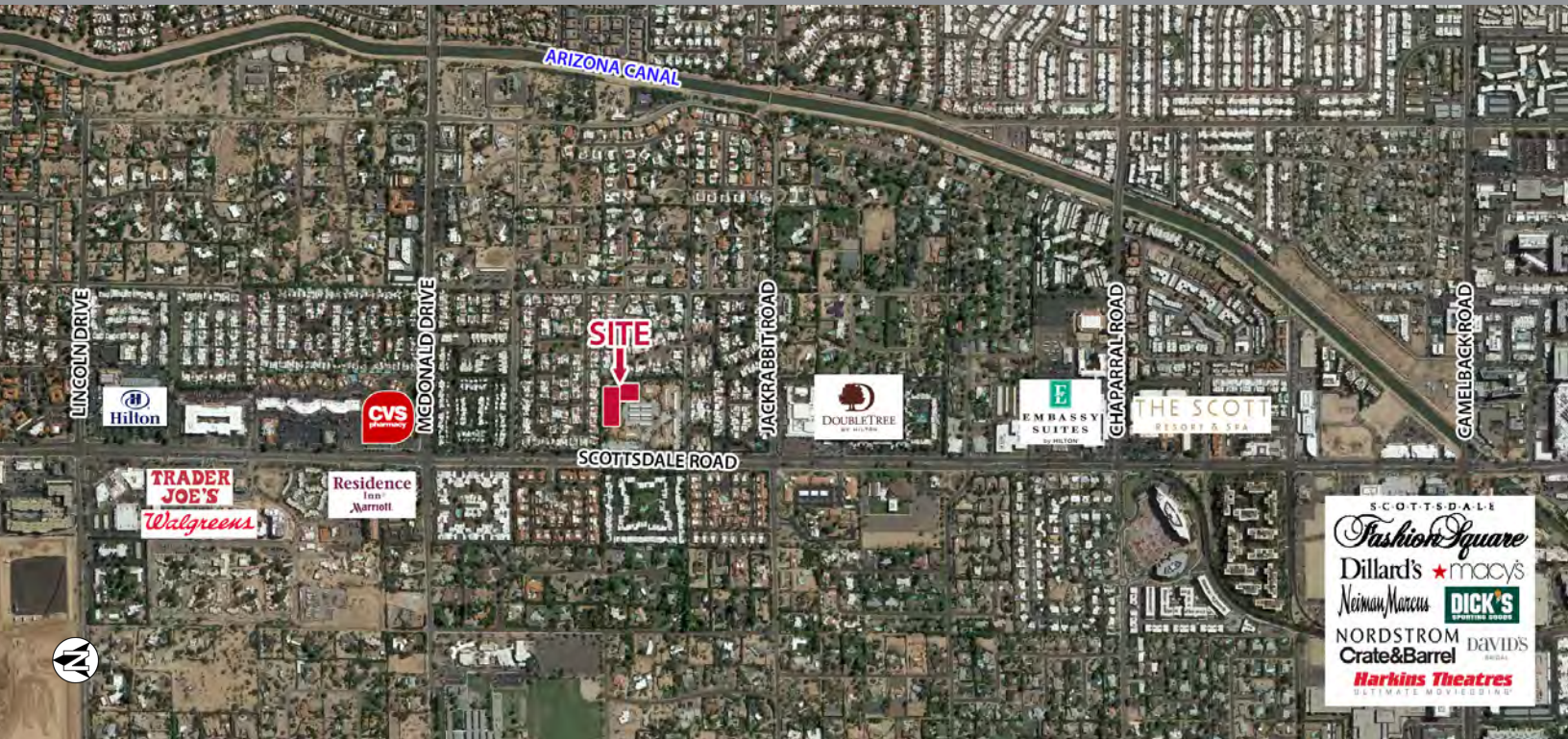

key features

- built-out office suites
- prime "Old Scottsdale" location, bordering downtown Paradise Valley, just north of Scottsdale
- covered parking, basement storage, and monument signage also available
- daily traffic count: 44,877 on Scottsdale Road

demographics

	1 mile	3 miles	5 miles
population	9,642	76,088	182,754
households	5,761	39,629	89,315
avg. household income	\$211,501	\$178,078	\$168,947
daytime population	11,236	88,133	192,372

2023 Estimates. Source: Applied Geographic Solutions 4/2023, TIGER Geography

office space for lease 351 – 6,164 sf

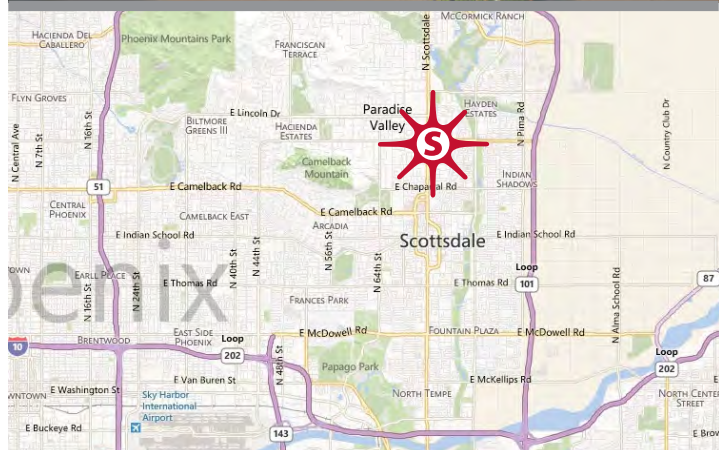

Lloyd Otani 480.949.9011 lotani@sandordev.com

5725 N. Scottsdale Rd., Suite C-195, Scottsdale, AZ 85250

www.sandordev.com
sandor

building c

UNIT	TENANT	S.F.
C-100	AVAILABLE	4,297
C-105	ADDISON TAYLOR FINE JEWELRY	1,200
C-110	OUT TO LUNCH RESTAURANT GROUP	2,860
C-120	AVAILABLE	760
C-135	PWI CONSTRUCTION	1,811
C-150	MEHDI MAZAHERI, M.D.	2,927
C-160	AVAILABLE	351
C-173	EDWARD JONES	814
C-195	SANDOR / SAND CAPITAL	5,595

building d

UNIT	TENANT	S.F.
D-100	PINECREST CAPITAL GROWTH	2,695
D-110	MILLENIUM DENTAL	2,115
D-120	AVAILABLE	6,164

