

# Topeka Commons

5900 SW Huntoon St.  
Topeka, KS 66604  
Shawnee County

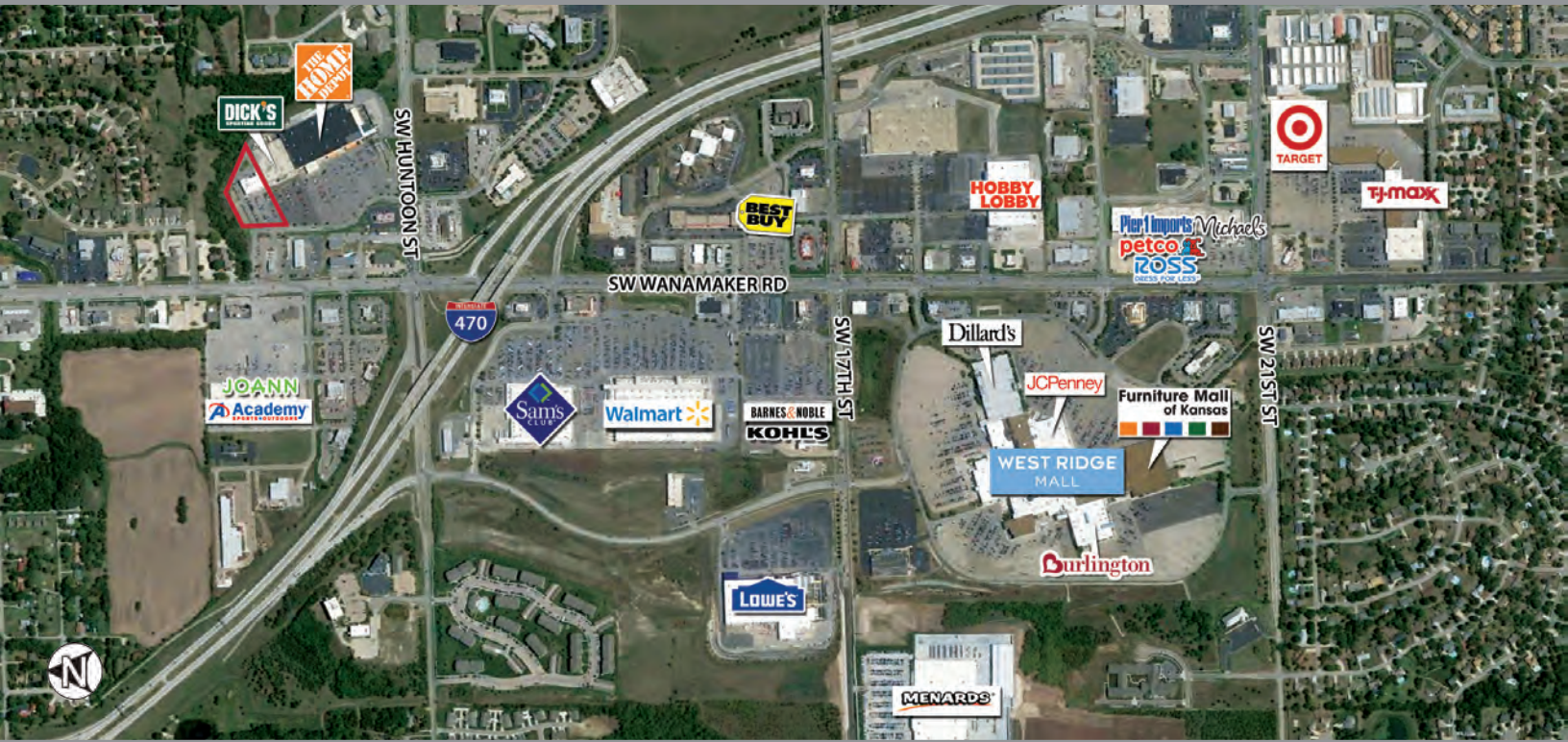

## key features

- located on main retail strip, 1/2 mile from West Ridge Mall
- anchored by The Home Depot and Dick's Sporting Goods
- easy access from I-70 and I-470
- daily traffic counts: 58,000 on I-70; 31,492 on I-470; 19,815 on Wanamaker Road; and 14,390 on Huntoon Street

## demographics

	1 mile	3 miles	5 miles
population	5,310	44,305	93,827
households	2,625	20,685	42,079
avg. household income	\$79,171	\$94,777	\$92,638
daytime population	7,397	40,084	96,808

2023 Estimates. Source: Applied Geographic Solutions 4/2023, TIGER Geography

**retail space for lease**      1,205 sf

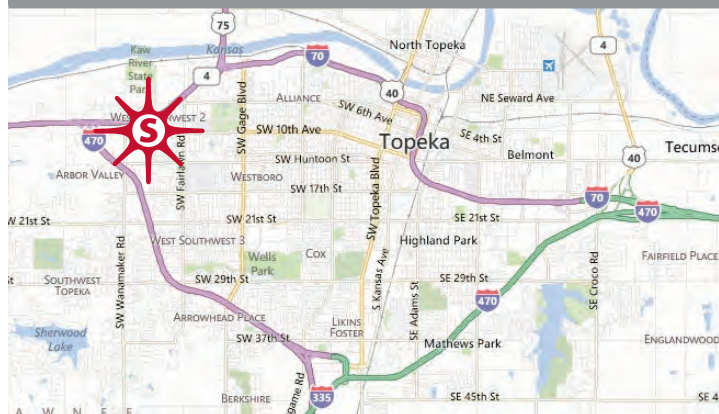

# Topeka Commons

5900 SW Huntoon St.  
Topeka, KS 66604  
Shawnee County

## phase II future development

UNIT	TENANT	DIMS.	S.F.
A1	MILAN LASER HAIR REMOVAL	17 x 100	1,700
A2	ESSENTIA SALON AND SPA	20 x 100	2,000
B	AVAILABLE	15 x 80	1,205
C	VAPOR WORLD	18 x 80	1,440
D	BEST NAILS	15 x 80	1,200
E	HUHOT MONGOLIAN GRILL	60 x 95	5,700

UNIT	TENANT	DIMS.	S.F.
A	FUTURE SHOP	15 x 80	1,800
B	FUTURE SHOP	15 x 80	2,000
C	FUTURE SHOP	15 x 80	1,205
D	FUTURE SHOP	40 x 60	1,440

