

Walmart Plaza

U.S. 89 and Haul Rd.
Page, AZ 86040
Coconino County



key features

- proposed retail center anchored by existing Walmart Supercenter
- outlots available from ±0.8 to ±10 acres
- retail growth area serving Lake Powell tourism

demographics

	3 miles	5 miles	10 miles
population	7,375	8,618	9,210
households	2,585	2,950	3,238
avg. household income	\$93,342	\$95,245	\$94,882
daytime population	3,795	4,107	4,255

2023 Estimates. Source: Applied Geographic Solutions 4/2023, TIGER Geography

outlots for sale/lease/build-to-suit

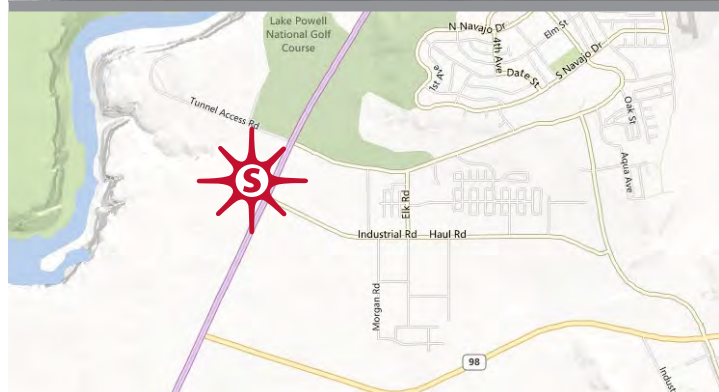

Jay D. Stein 480.949.9011 jdstein@sandordev.com

5725 N. Scottsdale Rd., Suite C-195, Scottsdale, AZ 85250

www.sandordev.com
sandor

outlots available

OUTLOT		SIZE
1D	AVAILABLE	±4.24 AC
1H	AVAILABLE	±0.8 AC
S1	AVAILABLE	±2.0 AC
S2	AVAILABLE	±2.0 AC
S3	AVAILABLE	±2.0 AC
S4	AVAILABLE	±2.0 AC
S5	AVAILABLE	±2.0 AC

