

# Walmart Plaza

100-132 W. George E. Phelps Blvd.  
Carthage, MO 64836  
Jasper County



## key features

- shadow-anchored by Walmart Supercenter
- located in Carthage's main retail trade area
- co-tenants include Goodwill, Dollar Tree, Verizon, and Great Clips
- recently painted facade

## demographics

	1 mile	3 miles	5 miles
population	2,730	17,949	22,707
households	1,157	6,566	8,335
avg. household income	\$60,187	\$66,744	\$72,623
daytime population	2,610	12,693	15,663

2023 Estimates. Source: Applied Geographic Solutions 4/2023, TIGER Geography

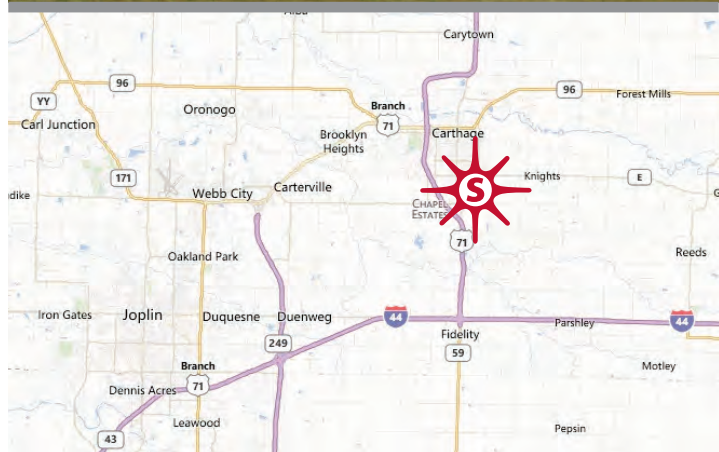

**retail space for lease**      1,287 – 4,725 sf

Tim Lee    317.524.7838    tlee@sandordev.com

10689 N. Pennsylvania St., Suite 100, Indianapolis, IN 46280

www.sandordev.com

**sandor**

# Walmart Plaza

100-132 W. George E. Phelps Blvd.  
 Carthage, MO 64836  
 Jasper County

## future development

UNIT	TENANT	DIMS.	S.F.
100	VERIZON	56.3 x 80	4,500
102	C NAIL SPA	21.3 x 80	1,700
104	GREAT CLIPS	15 x 80	1,200
112	DOLLAR TREE	122 x 80	9,760
120A	AVAILABLE	15.9 x 80	1,287
120B	AVAILABLE	16.1 x 80	1,291
122	AVAILABLE	43 x 110	4,725
124	LUMIO DENTAL	50 x 120	6,000
132	GOODWILL	103 x 110	11,330

UNIT	TENANT	SIZE
OUTLOT	AVAILABLE	± 3.0 AC

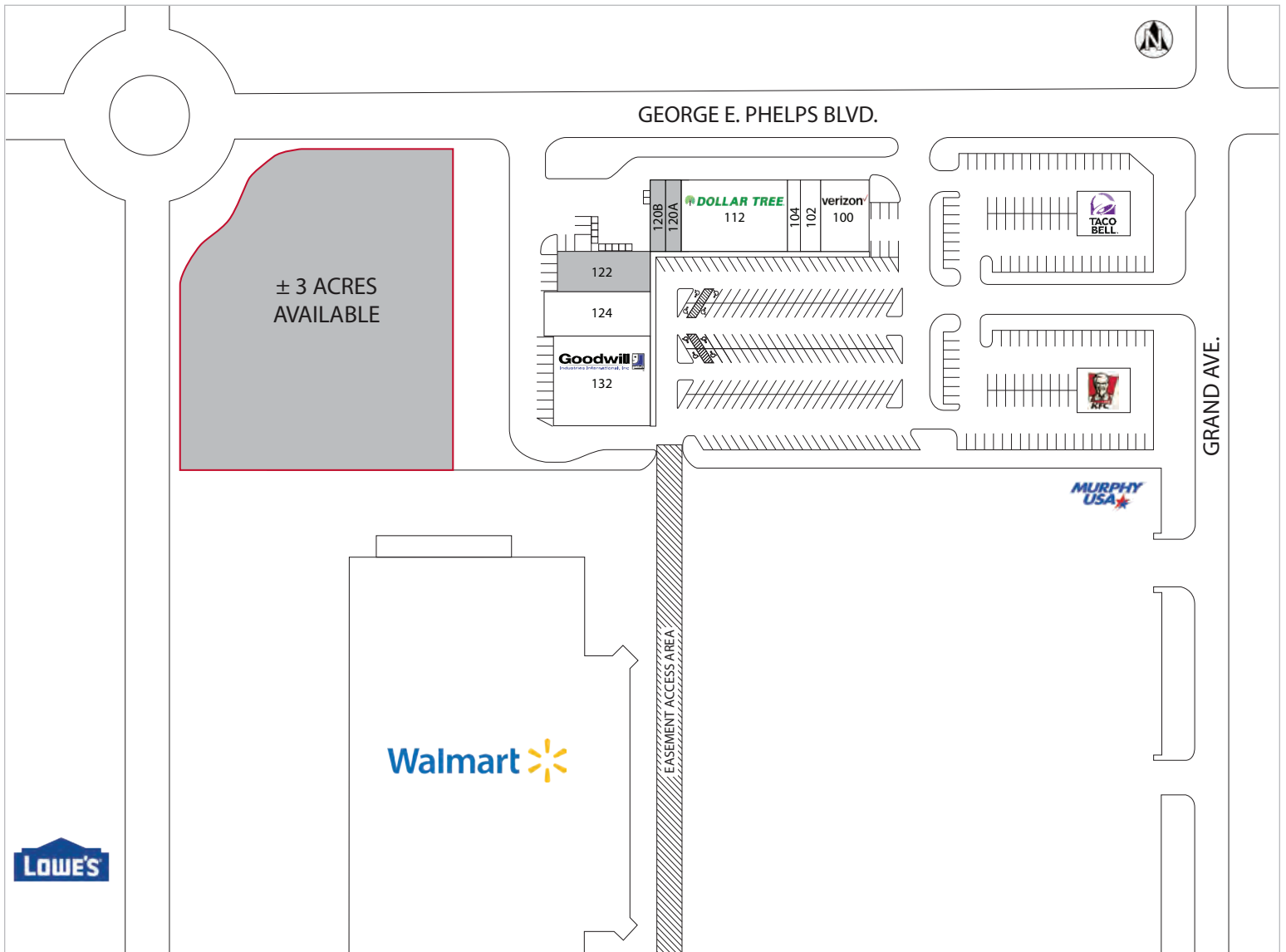

Tim Lee 317.524.7838 tlee@sandordev.com

10689 N. Pennsylvania St., Suite 100, Indianapolis, IN 46280

www.sandordev.com

**sandor**